

VENUE - TECHNICAL DATA

BASE

BASE

A COMMUNITY

FOR CULTURAL

PROGRESS

BASE

BASE

SPACE

BASE MILANO
OCCUPIES AN
AREA OF 12,000
SQUARE
METRES ON 3
LEVELS,
OVERLOOKING
VIA TORTONA.

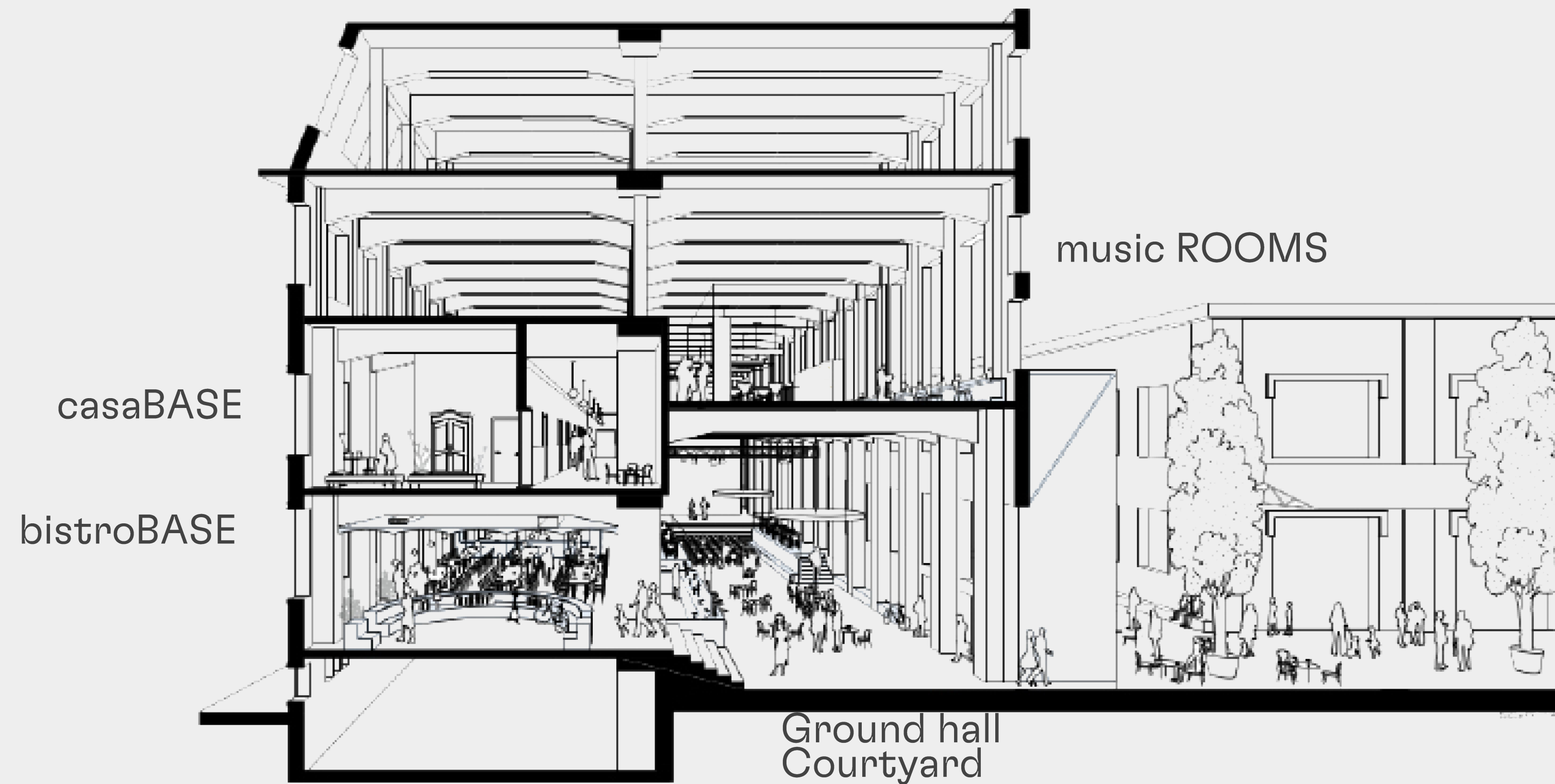

BASE

SPACE

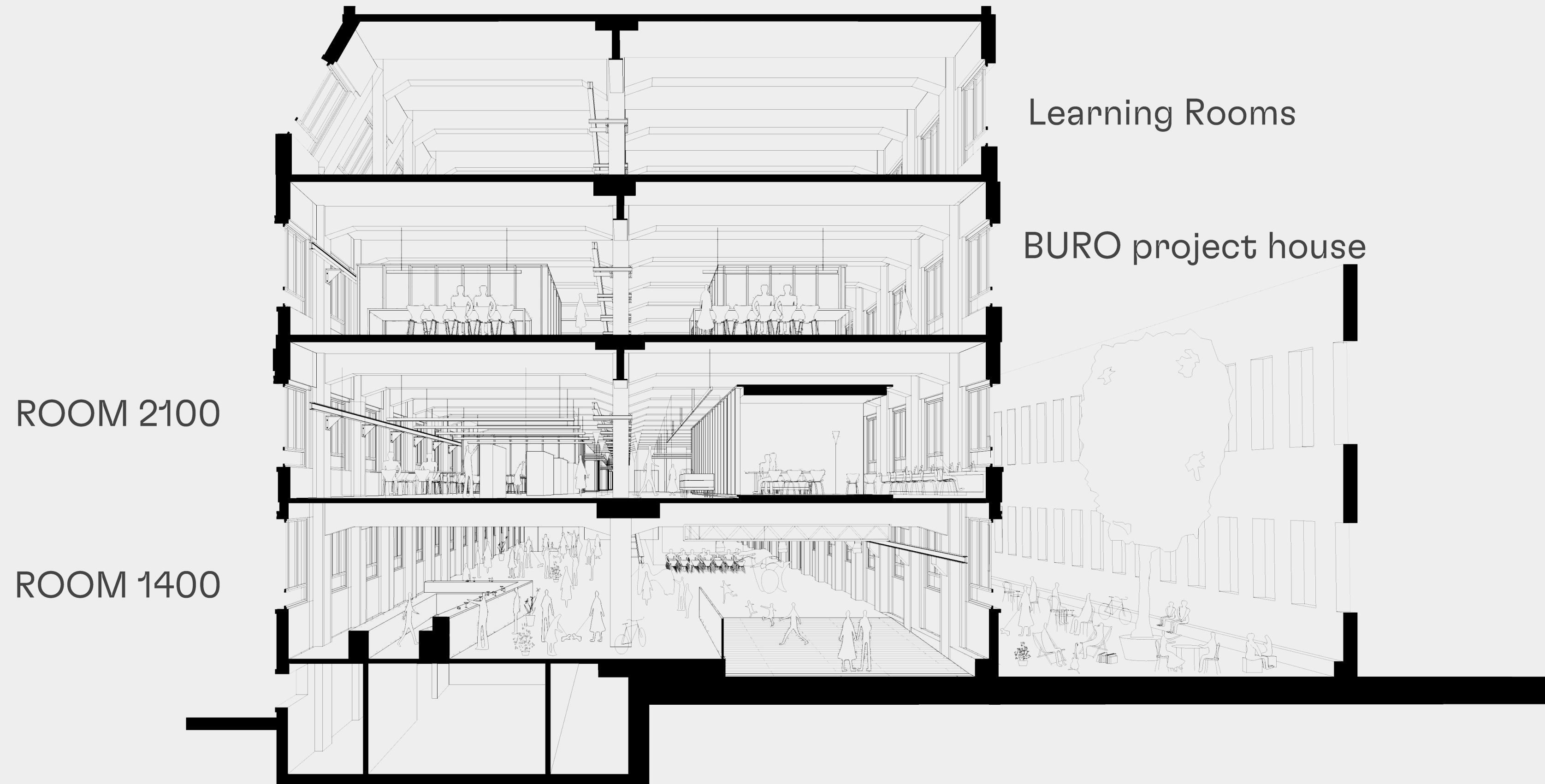

BASE

COURTYARD

Heart of the industrial complex and first port of call inside the former Ansaldo. In addition to the open-air bar, the courtyard offers tables, seating and a stage for live performances, suggestively built around a large tree.



DETAILS

ENTRANCE VIA BERGOGNONE 34 (370XH440CM)

ELECTRICAL DISTRIBUTION TO BE AGREED (15KW)

STAGE 4M X 6M X 0.6M

RING OF LUMINAIRES WITH 8 WARM WHITE LIGHTS



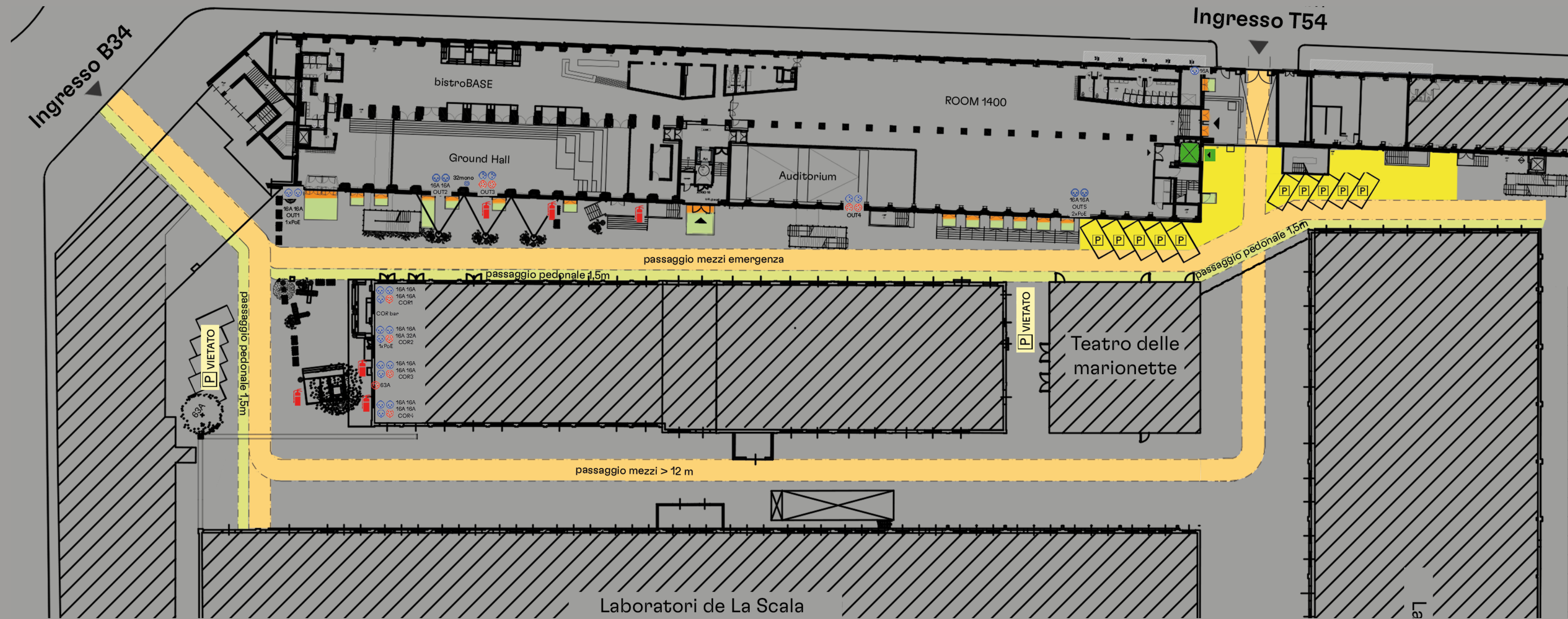

AUDIO TECHNOLOGY (ACTIVATION ON REQUEST)

BASE

COURTYARD



LEGEND

-  Unoccupiable area for vehicle passage
-  Unoccupiable area for pedestrians
-  Loading-unloading area
-  Area pertaining to U.S.
-  Panic door

AREA DIAGRAM

BASE

GROUND HALL

Main hall, heart of the entire building. Versatile and multifunctional with access from the courtyard. It can be used either in continuity with the bistroBASE space or separated by a system of walls along the colonnade.



DETAILS

GROUND FLOOR

400 SQM

HEATING/AIR CONDITIONING

ELECTRICITY 200 KW (KW INCREASE ON REQUEST)

BASEMILANO PUBLIC WI-FI NETWORK

TOILETS

COURTYARD ENTRANCE

H FLOOR 8.3M; H UNDER-BEAM 7.6M

HANGING SOUND SYSTEM

STAGE AREA LIGHTING SYSTEM

WOODEN STEP STAGE

ELECTRIC BLINDS FOR DARKENING HALL

BASE

GROUND HALL



BASE

BISTROBASE

The Bistro at BASE is open daily for breakfast, lunch, aperitifs, dinner and cocktail bar, and can also be used during private events with the catering service. During the summer BistroBASE moves to the courtyard.



DETAILS

MEZZANINE FLOOR

120 SQM (CAN BE EXTENDED IN THE BAR AREA ON REQUEST)

HEATING/AIR CONDITIONING

ELECTRICITY 200 KW (KW INCREASE ON REQUEST)

BASEMILANO PUBLIC WI-FI NETWORK

TOILETS

STAIR LIFT FOR THE DISABLED

H FLOOR 4.6M; H UNDER-BEAM 4.2M

AUDIO DIFFUSION SYSTEM

BASE

BISTROBASE



BASE

GROUND HALL E BISTRO

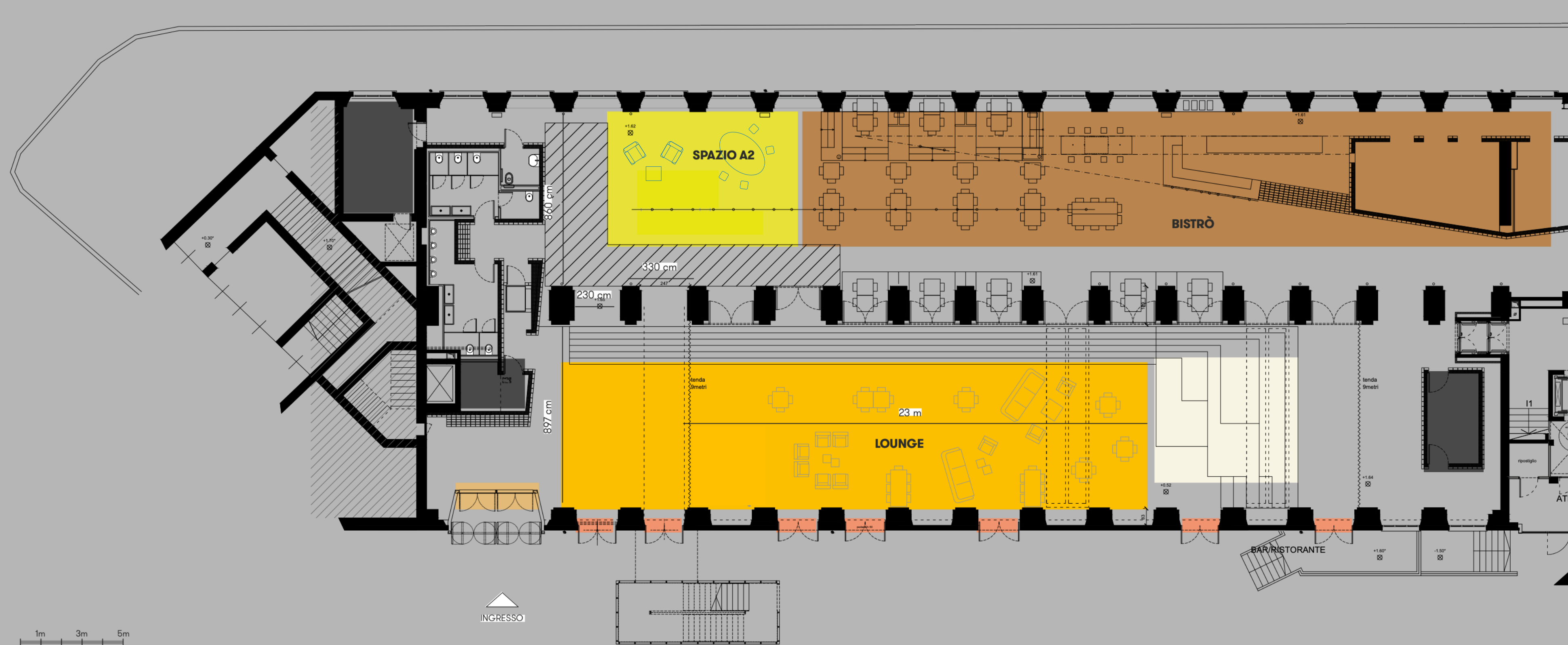

LEGEND

- Ground Hall
- Space A2 (48sqm)
- BistroBASE Space
- Entrance door (171L x 300H)
- Panic door (184L x 200H)
- Wooden stage
- Unoccupiable areas

AREA DIAGRAM

BASE

GROUND HALL E BISTRO

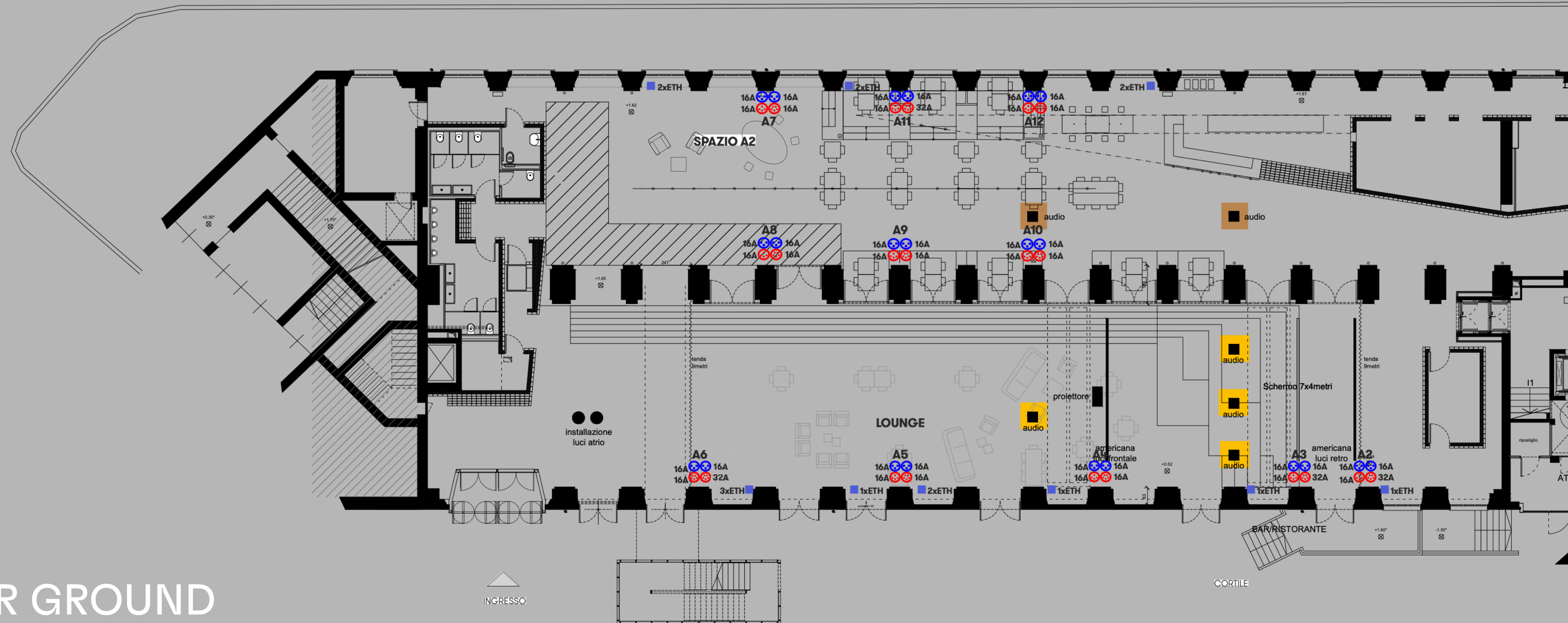

TECHNICAL RIDER GROUND HALL AND BISTRO

Modular and distributed audio diffusion system of the Mitus by FBT Line Array series. The entire system can be implemented as required. 32in-8out analogue spare transport. 2 CAT6 digital transports usable according to technical requirements.

VIDEO

OVERHEAD CRANE IN FRONT OF STAGE (FIXED)

PANASONIC RZ970 Projector - 1920x1080; 10,000 Ansilumen; DLP projection system, 7x4m roll-up screen

LIGHTS

AMERICAN STAGE FRONT

4 pc a led+ 2 par led rgb

AMERICAN BACKSTAGE

4 par led
1 strobo
6 led wash/beam

AUDIO - GROUND HALL

2 clusters hanging above stage, each consisting of: 2 Mitus 212FSA and 3 Mitus 206LA

1 delay hanging in the middle of the hall consisting of 4 Mitus 206LA

AUDIO - BISTRÒ

1 cluster hanging above bar consisting of 2 Mitus 206LA

BASE

ROOM 1400

A 1400 square metre space on the mezzanine floor, ideal for exhibitions, live music, projections, shootings and conferences (auditorium with 100 seats that can be darkened with curtains).

Possible independent access (via Tortona 54) plus bar and catering service on request.

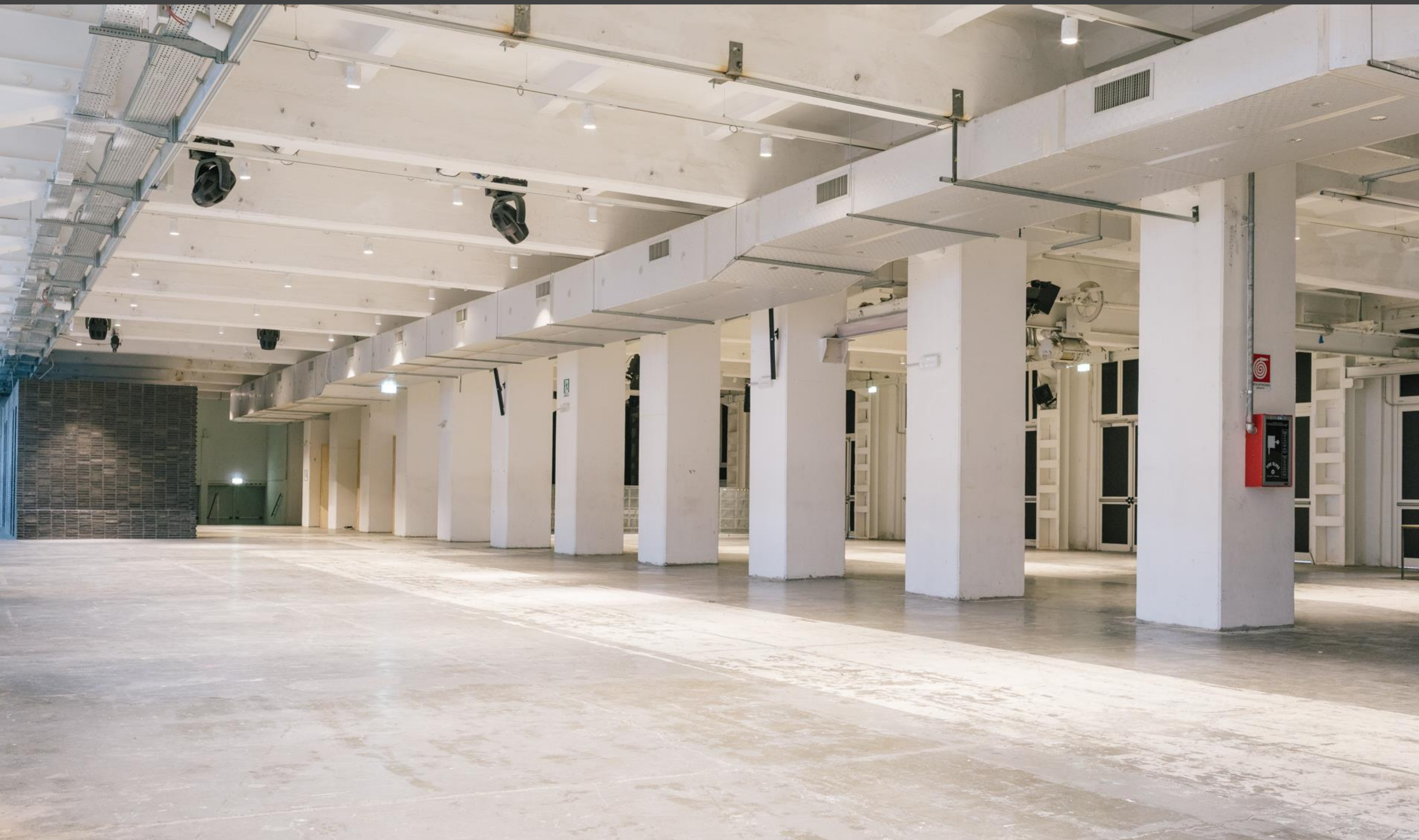

DETAILS

MEZZANINE FLOOR

1400 SQM

AUDITORIUM RAMP (CAN BE DARKENED WITH CURTAINS)

HEATING/AIR CONDITIONING

ELECTRICITY 200KW (KW INCREASE ON REQUEST)

TOILETS

COURTYARD ENTRANCE

LIGHT TRACKS, 3 LIGHTS PER TRACK

DEDICATED WI-FI ON REQUEST

HANGING EYEBOLT SYSTEM (100KG PER POINT)

H FLOOR 4.9M; H UNDER-BEAM MAX. 4.7M

LIFT SHARED WITH SPACE 2100

BASE

ROOM 1400





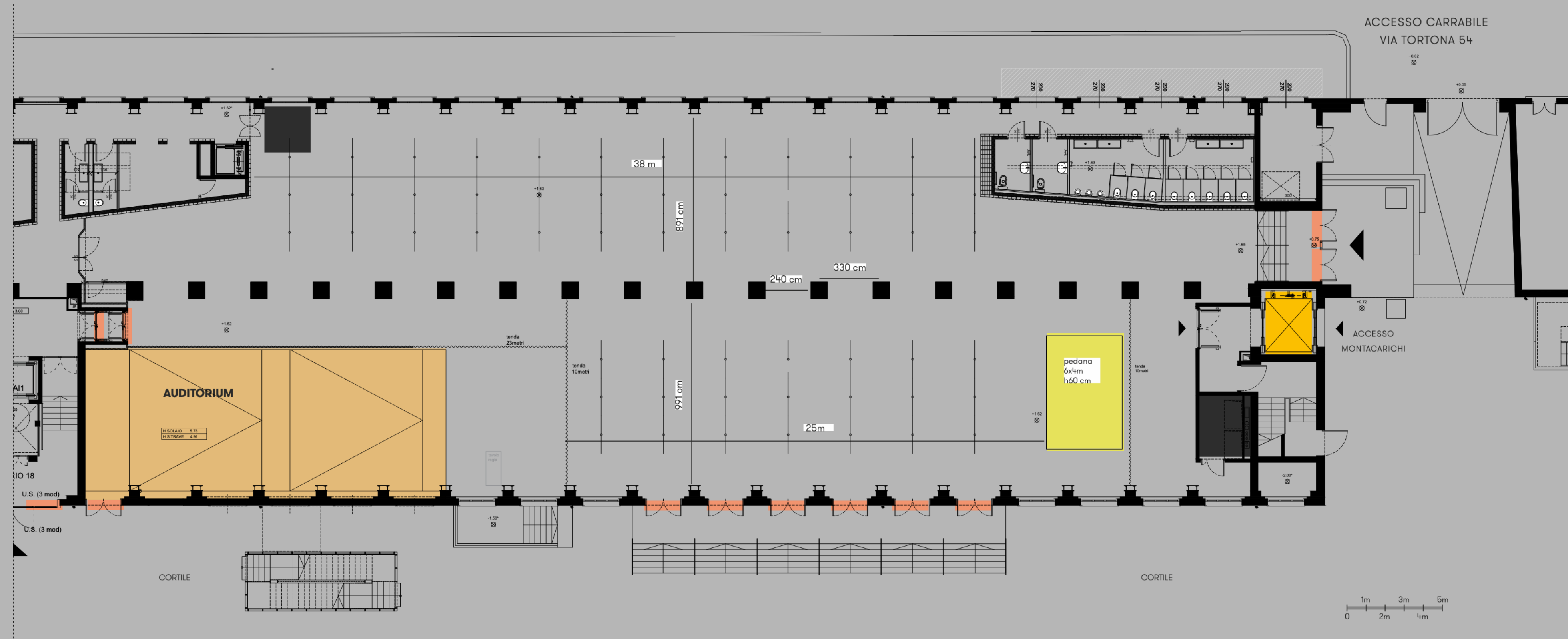

BASE

ROOM 1400



LEGEND

-  Elevator (200L x 280H x 170W)
-  Auditorium (144sqm)
-  Panic door (184L x 200H)
-  Unoccupiable areas
-  Stage (6 x 4m)

AREA DIAGRAM

BASE

ROOM 1400

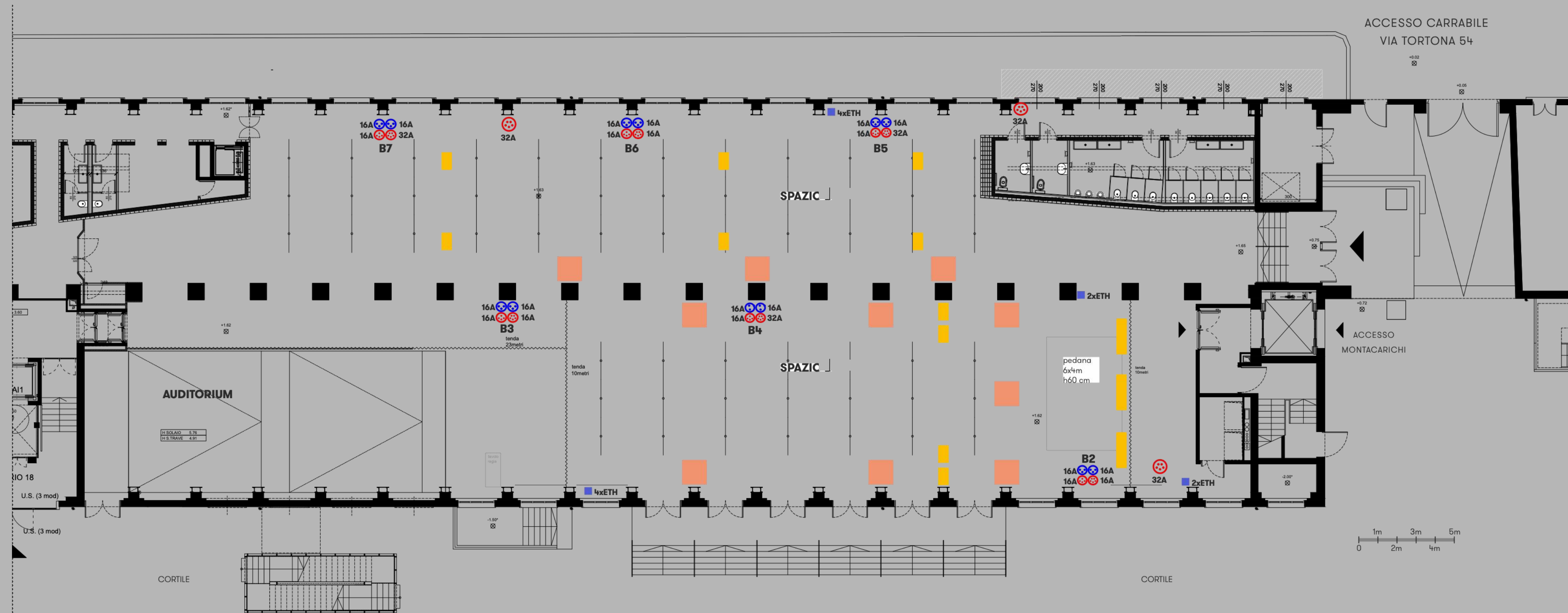

TECHNICAL RIDER ROOM 1400

The presence of a PA man resident technician is mandatory for the use of the system

MAIN PA

- TOP
4x k-array KX12 (2 per SIDE)
- SUB
2x k-array KMT211 (1 per SIDE)
- CENTRO/FRONT FILL
1x k-array KX12
- DELAY
Due linee di ritardo composte da 2 KX12 (1 per SIDE)

AUDIO DIRECTION

The hall has no resident sound desk, we can procure one through our suppliers.
Digital and analogue transport from stage area to control room
PA implementable if required

LIGHTS

The space has 4 headlamps for a white frontal
6 coemar ispot5757eb motorised retro
4 par rear
Lights are controllable via chamsys magicq interface on BASE laptop

broadcasting in the nave
bathrooms/bar
3x k-array KK102

amplification
2x k-array KA24
1x k-array KA84

stage monitors
2x k-array KM112
2x k-array KMT181

BASE

ROOM 2100

Large space of 1900 m² on the first floor of the building. It can be used in its entirety or split into two areas thanks to the use of movable walls. Ideal for exhibitions, shootings, conferences and workshops. Possibility of access via external staircase and independent entrance (via Tortona 54).



DETAILS

FIRST FLOOR

1900 SQM (DIVISIBLE INTO TWO)

LIGHT TRACKS

HEATING/AIR CONDITIONING

ELECTRICITY 200KW (KW INCREASE ON REQUEST)

TOILETS

DEDICATED WI-FI ON REQUEST

EYEBOLT SYSTEM FOR HANGING (100KG PER POINT)

STAIRCASE WITH LIFT

H FLOOR 4.6M; H UNDER BEAM MAX 3.9M

LIFT SHARED WITH SPACE 1400

ROOM2100 DOES NOT HAVE A RESIDENT TECHNICAL RIDER

BASE

ROOM 2100







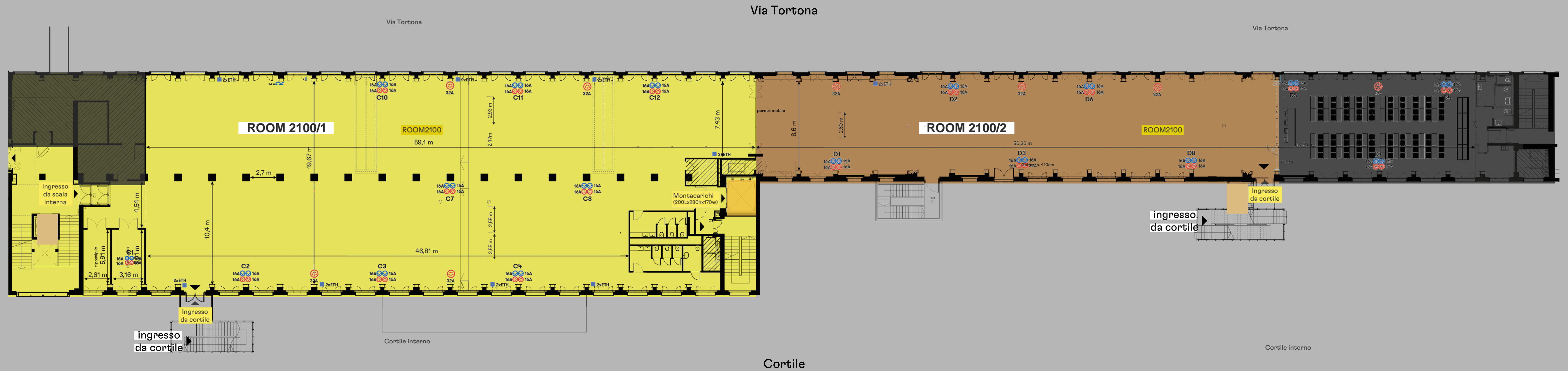

BASE

ROOM 2100



LEGEND

-  Freight elevator (200L x 280H x 170W)
-  Panic door (184L x 200H)
-  Unoccupiable areas
-  Room 1/ 1200 sqm
-  Room 2/ 700 sqm
-  Lift



AREA DIAGRAM

BASE

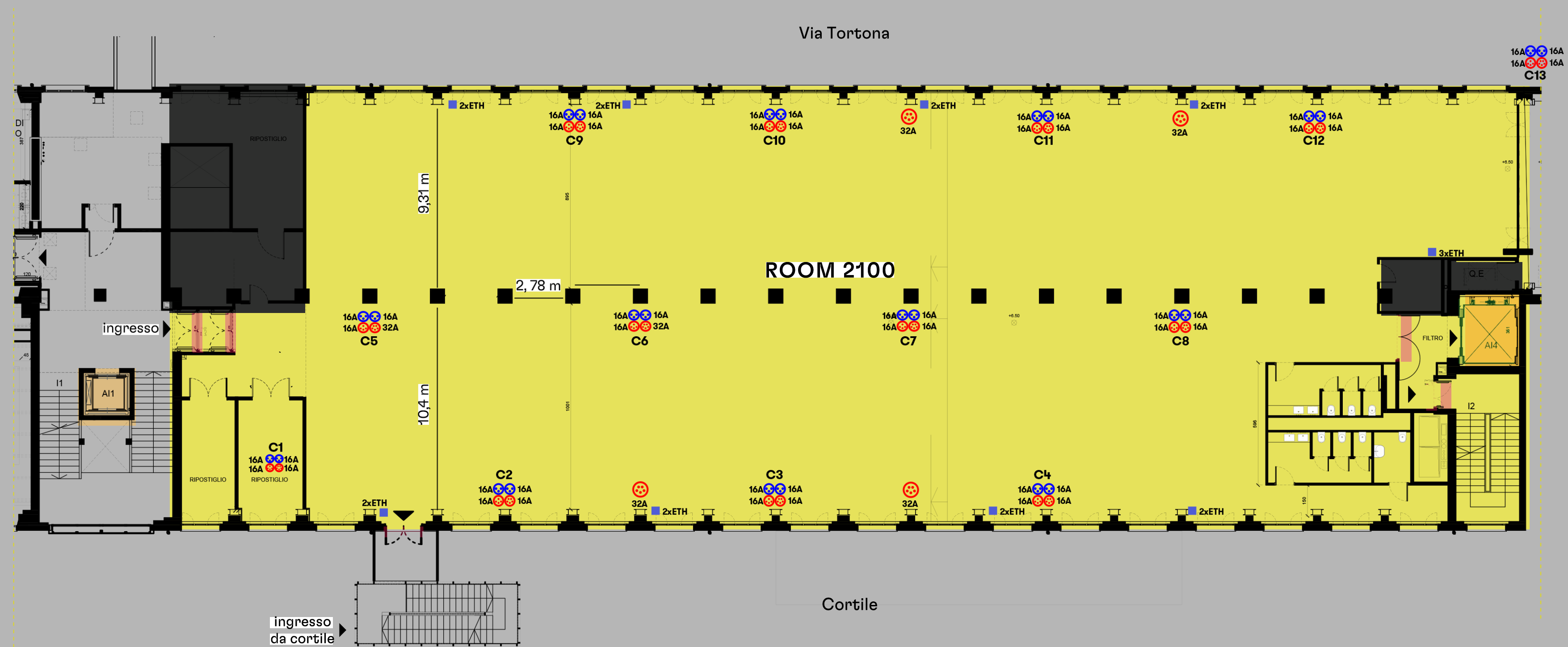
ROOM 2100 / 1

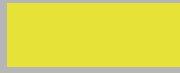

LEGEND

-  Total area 1200sqm
-  Freight elevator (200L x 280H x 170W)
-  Panic door (184L x 200H)
-  Unoccupiable areas
-  Lift



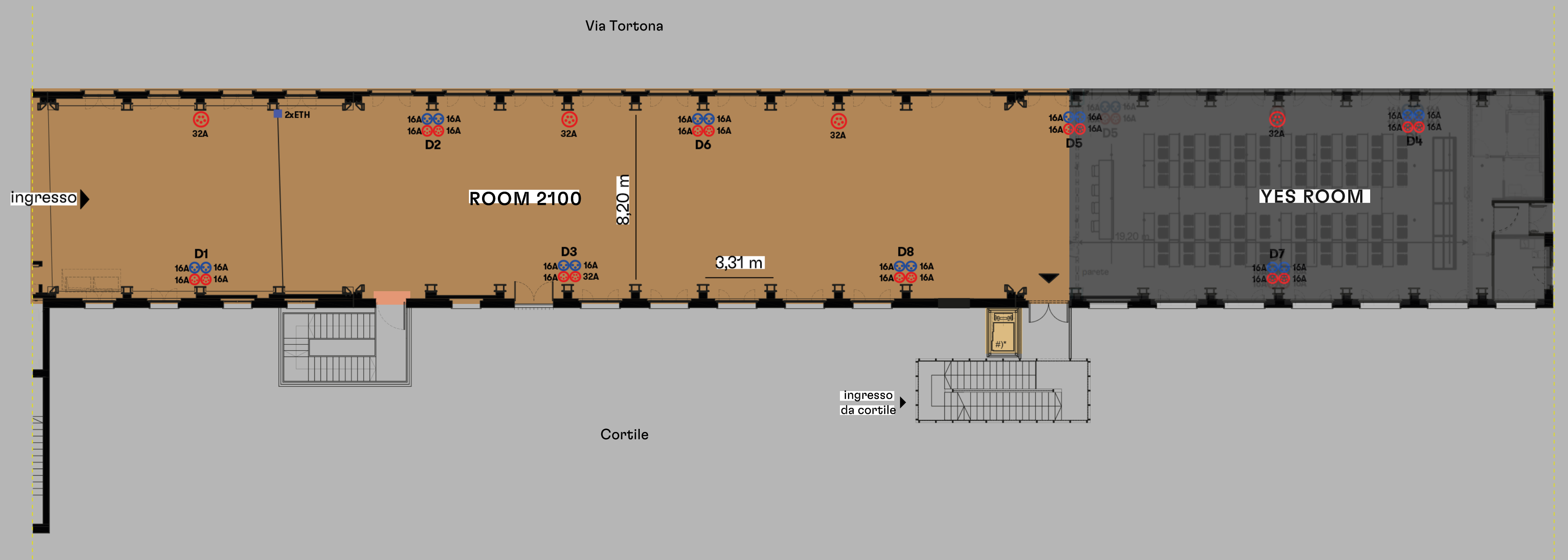

AREA DIAGRAM

BASE

ROOM 2100 / 2



LEGEND

-  Total area 700 sqm
-  Panic door (184L x 200H)
-  Unoccupiable areas
-  Lift

AREA DIAGRAM

BASE

CASABASE

An elegant 10-room artist's residence and hostel, this space is an ideal setting for photo and video shoots. It has a common area of 38 square metres with a kitchen, dining room and relax space. It is located on the first floor with access via an external staircase or internally by lift.



DETAILS

FIRST FLOOR

1 QUADRUPLE ROOM

1 DOUBLE ROOM

1 TWIN ROOM

5 DOUBLE ROOMS WITH PRIVATE BATHROOM

2 COMMUNAL BATHROOMS

COMMON AREA 38SQM

CORRIDOR 118SQM

220V CIVIL SOCKETS IN COMMON AREA ONLY
(1.5KW AVAILABLE)

ACCESS FROM EXTERNAL STAIRCASE

ACCESS FROM INTERNAL STAIRCASE WITH LIFT

BASE

CASABASE

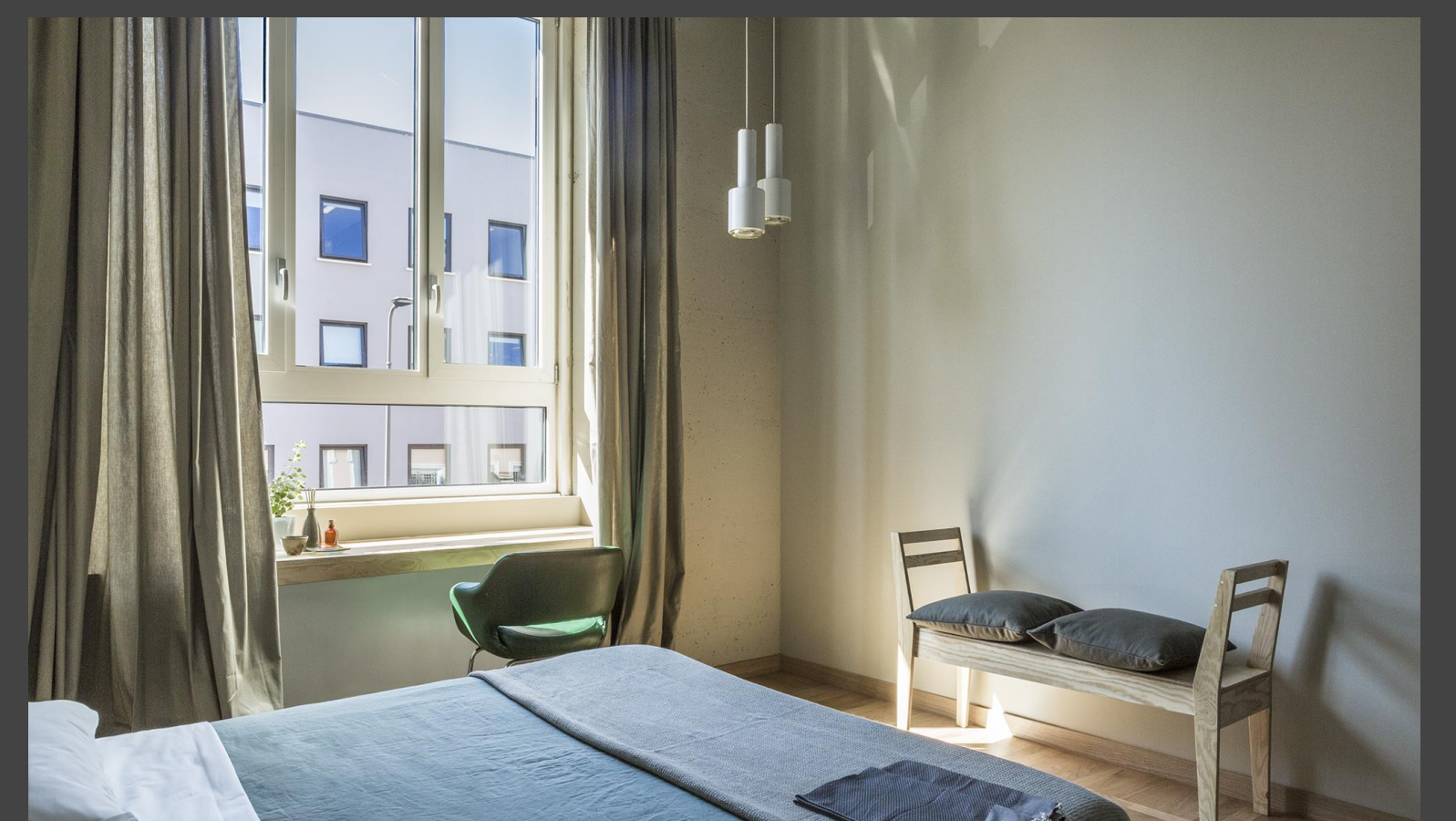

BASE

CASA BASE

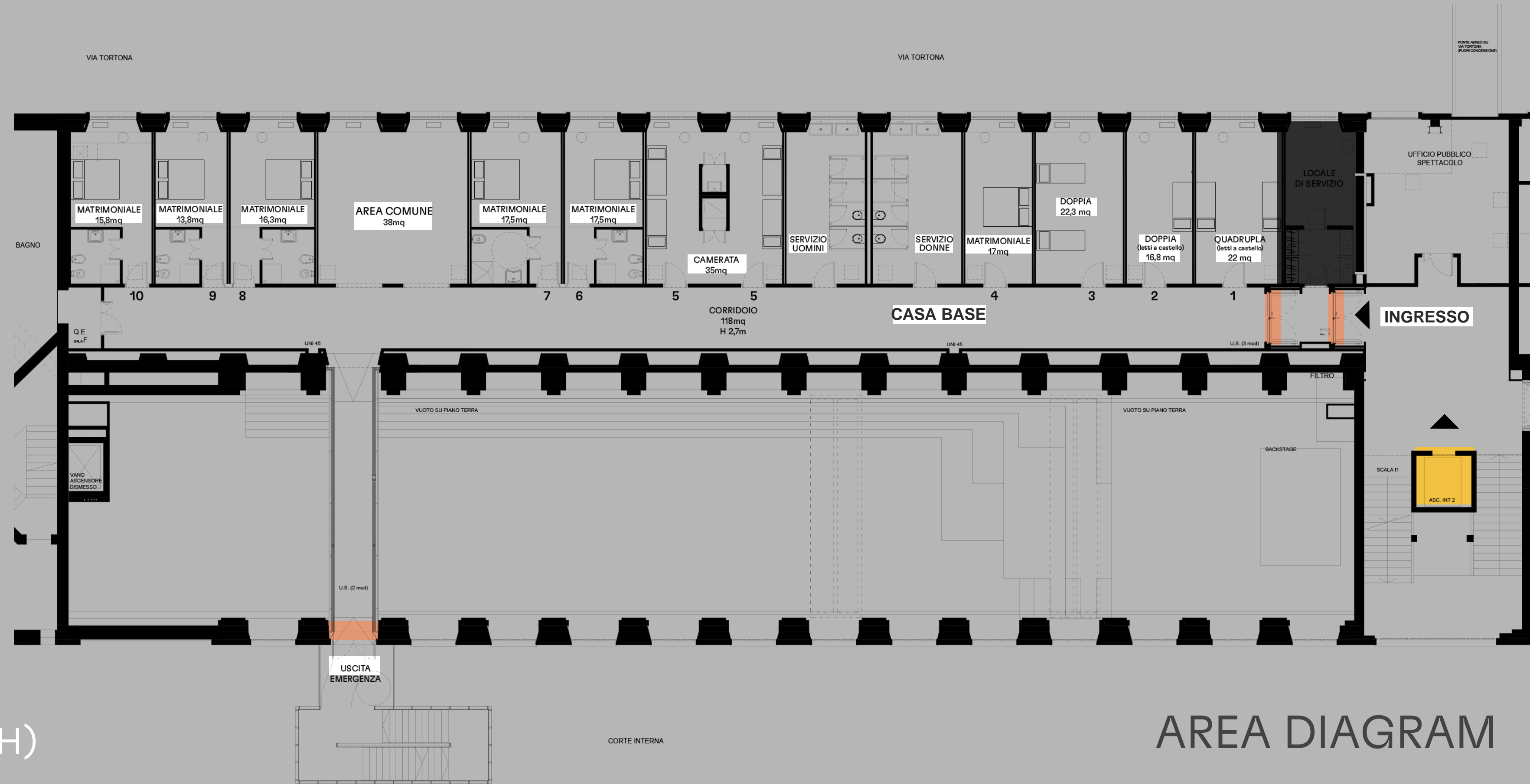

LEGEND

-  Panic door (184L x 200H)
-  Unoccupied areas
-  Lift

AREA DIAGRAM

BASE

MUSIC ROOMS

The music hub within BASE, located on the third floor of the building, where there is a multi-purpose space for training work, B2B and B2C events, showcases, backstage and coworking stations, for music professionals.



DETAILS

THIRD FLOOR

A WORKING AREA WITH AROUND 40 WORKSTATIONS

LA CAPSULA, A RECORDING STUDIO WITH 360° SOUND

WI-FI

ACCESS FROM EXTERNAL STAIRCASE





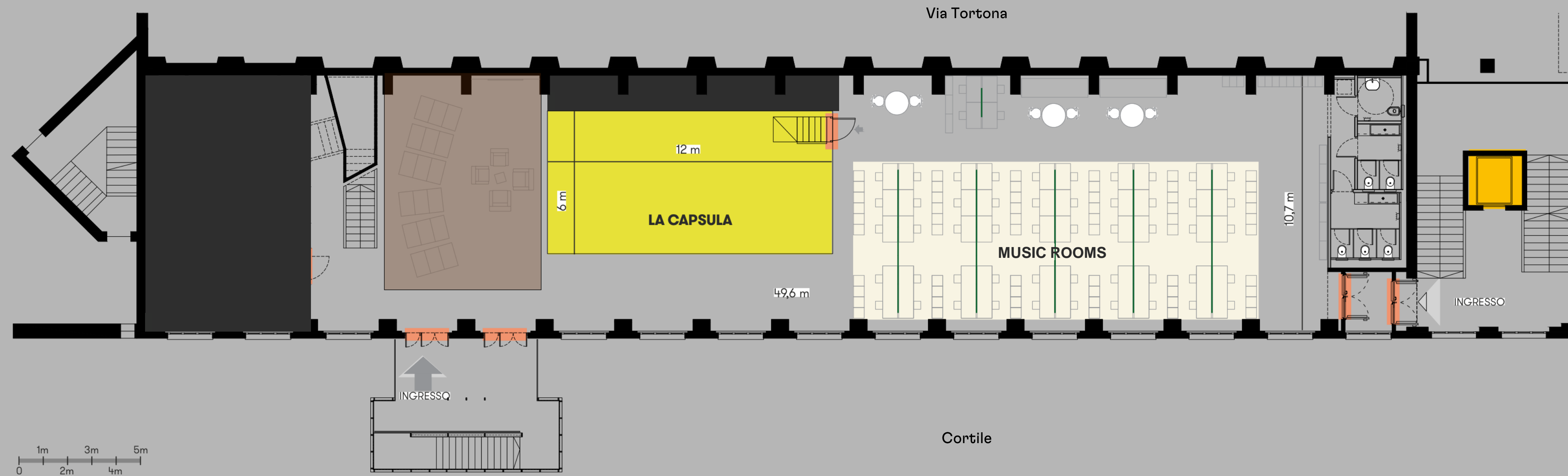

ACCESS FROM INTERNAL STAIRCASE WITH LIFT

BASE

MUSIC ROOMS



LEGEND

-  La Capsula (72sqm)
-  Coworking area // not for rent
-  Panic door
-  Lift
-  Unoccupiable area
-  Amphitheatre

AREA DIAGRAM

BASE

MUSIC ROOMS

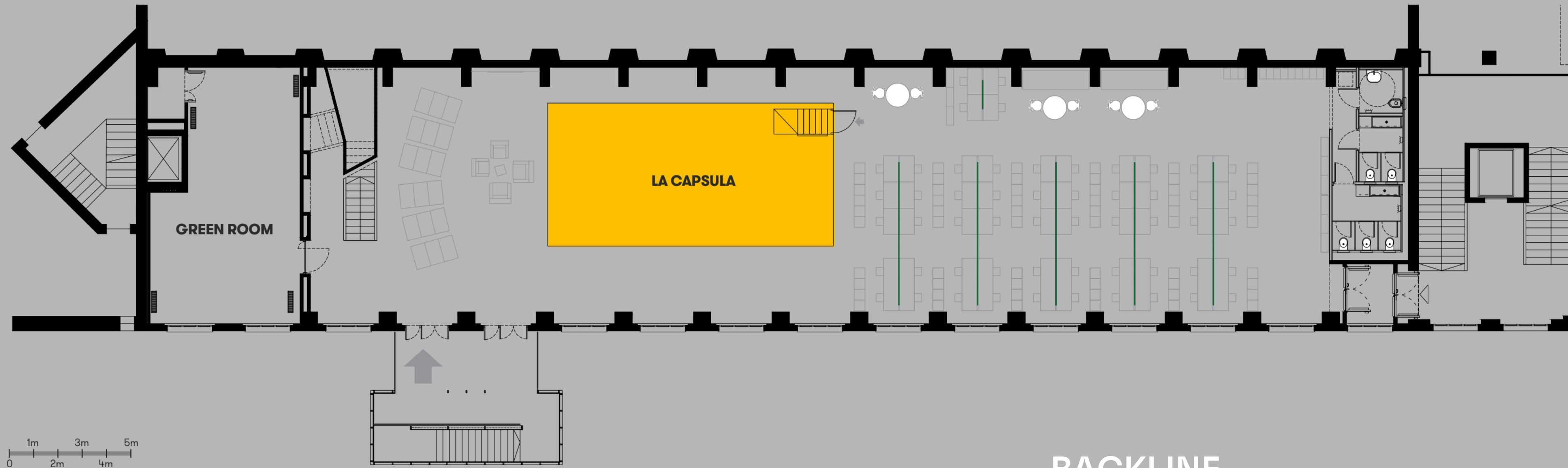

CAPSULE TECHNICAL RIDER

LA CAPSULA is a 60sqm box equipped for 360° filming and streaming with immersive 3D sound.

SOFTWARE / IT

- 01x Facebook 360
- 01x intorno LABS 3D audio engine
- 01x intorno LABS Ableton live plug-in
- 01x app intorno LABS SPC
- 01x max8
- 01x Ableton live 10 suite
- 01x OBS
- 02x mac mini
- 01x NUC

MICS

- 02x AKG C 451 B
- 01x AKG D112
- 01x AKG P170
- 03x SHURE SM58
- 06x SHURE SM57

VIDEO

- 01x camera AXIS 360 + remote controls
- 02x blackmagic microstudio camera 4K
- 01x blackmagic ATEM 1 M/E production studio 4K
- 01x blackmagic web presenter
- 04x TV monitor FULL HD 22" philips 223V5LSB2

AUDIO

- 24x yamaha HS8i
- 08x yamaha HS5i
- 04x yamaha HS8S
- 01x yamaha TF1
- 01x yamaha TIO1608D
- 01x yamaha SWP1-8 network switch
- 01x yamaha SWR 2100P
- 01x tascam 32D converter AD/DA
- 01x dante virtual soundcard licence
- 01x dante avio adaptor IN
- 01x dante avio adaptor OUT
- 01x dante avio adaptor USB
- 01x behringer powerplay P16-I
- 04x behringer powerplay P16-M
- 05x headphone

BACKLINE

- 02x music stand
- 02x guitar stand
- 02x keyboard stand
- 10x mic stand tall
- 01x mic stand little
- 01x kick mic stand
- 04x D.I. klark teknik DN 100
- 01x pearl HWP-830 hardware set
 - 01x BC-830 cymbal boom stand
 - 01x C-830 straight cymbal stand
 - 01x H-830 hi-hat stand
 - 01x S-830 snare stand
 - 01x P-930 single bass drum pedal
- 01x yamaha stage custom
 - 01x kick 22" + 02x CL945B
 - 04x tom 10"/12"/14"/16" + 01x CL945B
- 01x pearl D-790 drum throne
- 01x ampeg SVT-410 HE bass amp
- 01x fender twin reverb 65 guitar amp
- 01x DJ multieffect box intorno labs 01x akai MPD218

LEARNING ROOMS

BASE



LEGEND

- Room 1
- Room 2
- Reception + area real

ROOM 1

BASE



DETAILS

THIRD FLOOR

50 SQM

HEATING/AIR CONDITIONING

1 MONITOR 82 INCHES + PC

CONFIGURATION WITH TABLES AND CHAIRS,
WITH FRONTAL SEATING OR MEETING ROOM
VERSION WITH A SINGLE TABLE

TOILETS SHARED WITH AULA 2

COVERED ENTRANCE FROM VIA TORTONA 56
(STAIRS ONLY) OR FROM EXTERNAL STAIRCASE
WITH LIFT FROM VIA TORTONA 54

ELECTRIC BLINDS FOR ROOM BLACKOUT

RECEPTION AND BREAK AREA SHARED WITH
CLASSROOM 2

MAXIMUM CAPACITY 30 PEOPLE

ROOM 1



ROOM 2

BASE



DETAILS

THIRD FLOOR

115 SQM

CAN BE DIVIDED BY MOVABLE PARTITION INTO TWO SMALLER ROOMS OF 33 PAX EACH

HEATING/AIR CONDITIONING

1 MONITOR 82 INCHES + PC

CONFIGURATION WITH TABLES AND CHAIRS OR WITH FRONT STALLS

TOILETS SHARED WITH CLASSROOM 1

COVERED ENTRANCE FROM VIA TORTONA 56 (STAIRS ONLY) OR EXTERNAL STAIRCASE WITH LIFT FROM VIA TORTONA 54

ELECTRIC BLINDS FOR ROOM BLACKOUT

RECEPTION AND BREAK AREA SHARED WITH AULA 1

MAXIMUM CAPACITY: 66 PEOPLE

ROOM 2



BASE

TERRACE

The large 500 m² terrace located on the rooftop of the building, overlooking the city of Milan and ideal for shooting and filming. It has a corner bar that can be activated upon request using the bistroBASE catering service. Restricted access is guaranteed.



DETAILS

ROOFTOP

BAR AREA

TOTAL SURFACE 500 MQ

EQUIPPED WITH TABLES AND SEATS

RESERVED ACCESS

220V ELECTRICAL PLUGS AVAILABLE

INDUSTRIAL PLUGS AVAILABLE

WATER POINTS

MAXIMUM CAPACITY: 66 PERSONS

BASE TERRACE



BASE

TERRACE

VIA TORTONA

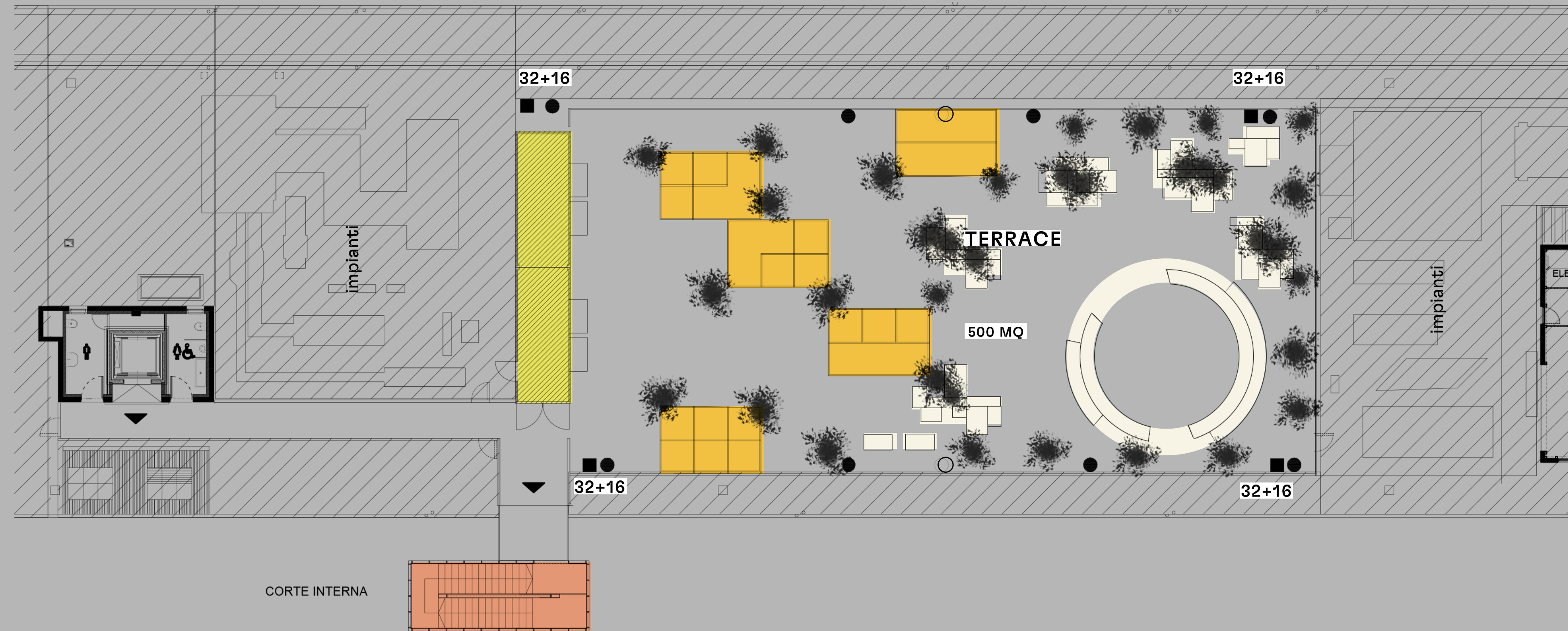

LEGEND

-  Covers - gazebos
-  Bar area
-  seats
-  External staircase exit
-  Shuko socket
-  Water point
-  Industrial socket

BASE

USE OF OUTDOOR
COURTYARD FOR
LOADING AND
UNLOADING

SERVICES

UTILITIES
(HEATING,
CONDITIONING
CHIN, LIGHT,
ELECTRICITY)

TOILET
SERVICES
-
FREE WIFI

BASE

PORTIONING OF SPACES THROUGH THE ASSEMBLY OF MOBILE WALLS

CATERING
(EXCLUSIVE SERVICE WITH OUR INTERNAL SUPPLIER)

GUEST ACCOMMODATION

EXTRA SERVICES

CLEANING SERVICE, SECURITY AND LIFTERS

SETTING UP MATERIALS AND FURNITURE

HOSTESS AND WARDROBE SERVICE

TECHNICAL SERVICE FOR AUDIO, LIGHTS AND VIDEO
ELECTRICITY DISTRIBUTION

PERMITS MANAGEMENT AND SECURITY PROTOCOL

MEDIA AND COMMUNICATION PACKAGE

BASE

THANKS.